

Bolt Type Test Plug - Technical Specifications

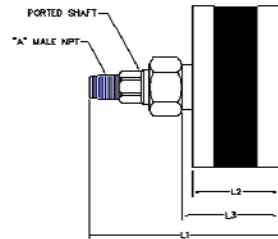

2.17 – 8.50

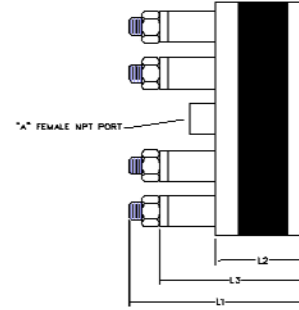

8.51 – 10.50

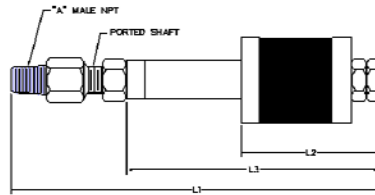

.500 – 2.169

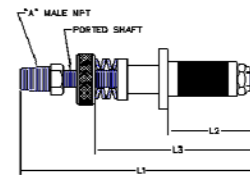

.280 – .499

Tube ID Range		Shaft OD		Shaft Quantities	Shaft/Port Diameter		"A" NPT Size	L1		L2		L3		Max. Op. Pressure		Shaft Hex Wrench Size (in)	Hex Nut Wrench Size (in)	Approximate Shipping Weight	
(in)	(mm)	(in)	(mm)		(in)	(mm)		(in)	(mm)	(in)	(mm)	(in)	(mm)	(psi)	(bar)			(lbs)	(kgs)
.280 - .499	7.11 - 12.69	1/4-1/8 (STEPPED)	6.4 - 3.2	1	0.06	1.5	1/8 M	4 1/4	108.0	1 1/8	28.6	2 3/8	60.3	250	17.2	9/16	Knurled nut	0.30	0.14
.500 - .719	12.70 - 18.27	1/4	6.4	1	0.12	3.0	1/8 M	4 3/8	111.1	1 3/4	44.5	2 3/4	69.9	250	17.2	9/16	7/16	0.25	0.11
.720 - .869	18.28 - 22.08	1/4	6.4	1	0.12	3.0	1/8 M	4 3/8	111.1	1 3/4	44.5	2 3/4	69.9	175	12.0	9/16	7/16	0.25	0.11
.870 - 1.099	22.09 - 27.69	3/8	9.5	1	0.19	4.8	1/8 M	6 3/8	161.9	2 1/16	52.4	4 7/16	112.7	175	12.0	9/16	9/16	0.50	0.23
1.100 - 1.429	27.94 - 36.31	3/8	9.5	1	0.19	4.8	1/8 M	6 3/8	161.9	2 3/16	55.6	4 9/16	115.9	175	12.0	9/16	9/16	0.60	0.27
1.430 - 1.779	36.32 - 45.20	3/8	9.5	1	0.19	4.8	1/8 M	6 3/8	161.9	2 3/16	55.6	4 9/16	115.9	75	5.1	9/16	9/16	0.80	0.36
1.780 - 2.169	45.21 - 55.11	3/8	9.5	1	0.19	4.8	1/8 M	6 3/8	161.9	2 5/16	58.7	4 11/16	119.1	75	5.1	9/16	9/16	1.00	0.45
2.17-3.50	55.12 - 89.14	5/8	15.9	1	0.31	7.9	1/4 M	4 3/8	111.1	1 3/4	44.5	2	50.8	50	3.4	1/2	15/16	2.75	1.25
3.51 - 4.50	89.15 - 114.54	7/8	22.2	1	0.44	11.2	3/8 M	4 5/8	117.5	1 3/4	44.5	2	50.8	40	2.7	11/16	1 5/16	4.50	2.04
4.51-6.50	114.55 - 165.34	1 1/4	31.8	1	0.56	14.2	1/2 M	6 3/4	171.5	3	76.2	3 1/4	82.6	25	1.7	1	1 7/8	13.00	5.89
6.51-8.50	165.35 - 216.14	1 1/2	38.1	1	0.75	19.1	3/4 M	7 3/8	187.3	3 1/2	88.9	3 3/4	95.3	15	1.0	1 1/4	2 1/4	28.50	12.91
8.51-10.50	216.15 - 266.95	5/8	15.9	6	0.75	19.1	3/4 F	6 1/8	155.6	2 1/2	63.5	4 7/8	123.8	10	0.7	n/a	15/16	40.00	18.12



EST Group
2701 Township Line Rd
Hatfield, PA 19440-1770 USA
(P) 215.721.1100
800.355.7044
(F) 215.721.1101
est-info@curtisswright.com
http://estgroup.cwfc.com

Europe / Middle East / Africa
EST Group B.V.
Hoorn 312a
2404 HL Alphen aan den Rijn
The Netherlands
(P) +31.172.418841
(F) +31.172.418849
est-emea@curtisswright.com

Asia
EST Group Asia
35 Tannery Rd, #11-10 Tannery Block
Ruby Industrial Complex
Singapore 247740
(P) +65.6745.8560
(F) +65.6742.8700
est-asia@curtisswright.com